

What's in the Box

Overview

Installing the Battery

Using Your Cooler

Powering On/Off

Screen Guide

Connecting Your Cooler

Setting the Temperature

Powering Your Cooler

AC Powering

Car Powering

USB-C Powering

Solar Powering (100 W Max, 12 V-30 V)

Maintenance Best Practices

FAQ

Specifications

What's in the Box

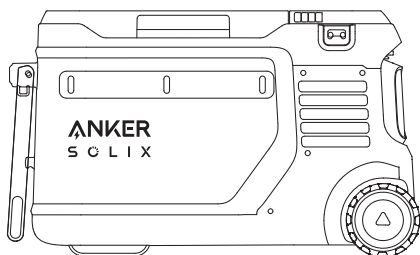

Anker SOLIX EveFrost 2 23L
Electric Cooler

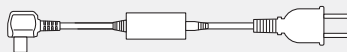

AC Adapter and Charging Cable



Car Charging Cable

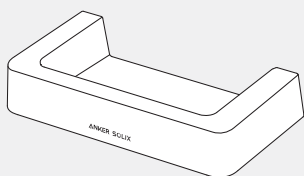

Wheel Holder
(x2)



Documents

Overview

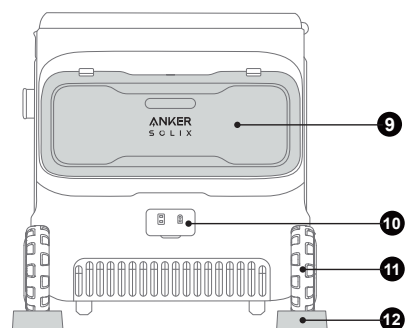
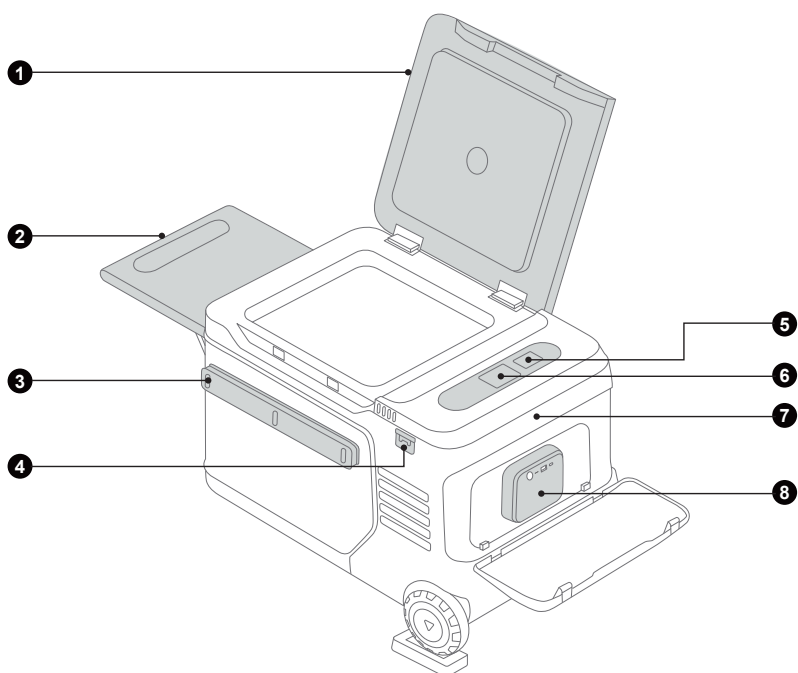

❶ Cooler Cover

❷ Tray Table*

Note: Load capacity is 30 kg (66 lb).

❸ Bar**

Note: For accessories such as rod and knife racks, tabletops, and cups, align the protruding strip at the back of the accessory with the notch on the bar and insert it fully. Refer to the accessory instructions for details. Accessories can be purchased separately.

❹ Bottle Opener

❺ Buttons

❻ Display

❼ Handle

❽ Battery

❾ Battery Cover

❿ Input Ports

⓫ Wheel

⓬ Wheel Holder

*Using the tray table:

1. Lift the tray table.

2. Apply moderate force to release the stand, then secure it into place.

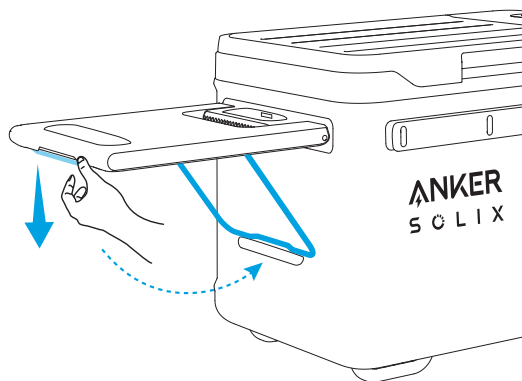
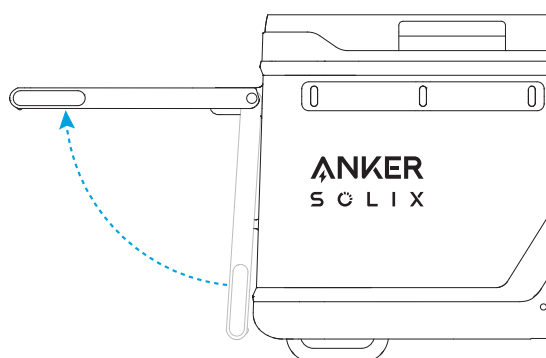

**Using the bar :

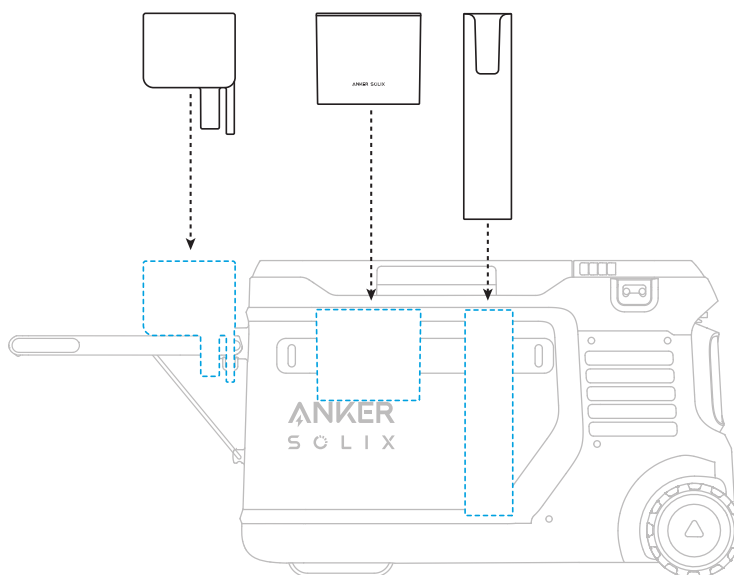

Installing the Battery

- If there is already a battery in the cooler, please skip this step.
- The cooler can be installed with one or two batteries. When using one battery, please install it in the right battery compartment. Do not place any objects in the empty battery compartment to avoid contamination of the internal battery contact pins, which could lead to poor battery contact or a short circuit.

Open the battery cover. Place the battery inside, and you will hear a click when the installation is successful. If the cooler is turned on, the screen will display "Battery Connected." Close the battery cover. To remove the battery, lift its handle.

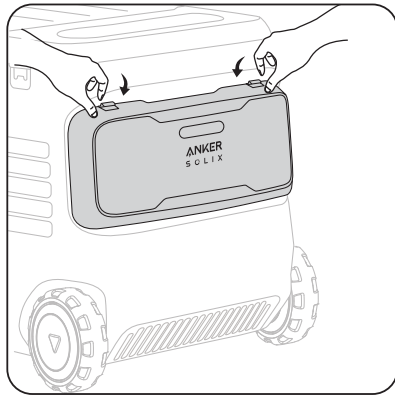

1

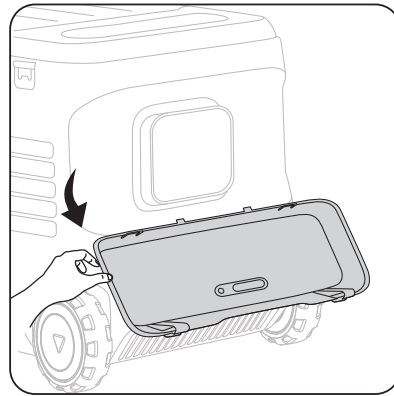

2

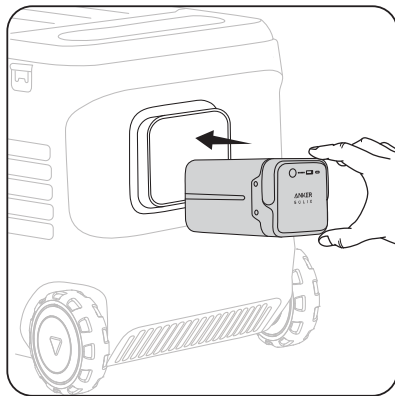

3

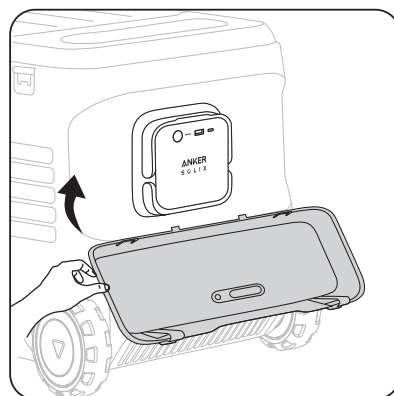

4

Using Your Cooler

Powering On/Off

- To ensure reliable compressor operation after long transportation, lay the cooler flat for three hours before turning it on for the first time. Ensure the cooler is connected to the mains power with a charger or has a battery inside before turning it on.
- **Before using the cooler for the first time, recharge it to activate.**

Press <⏻> for 3 seconds to turn your cooler on or off.

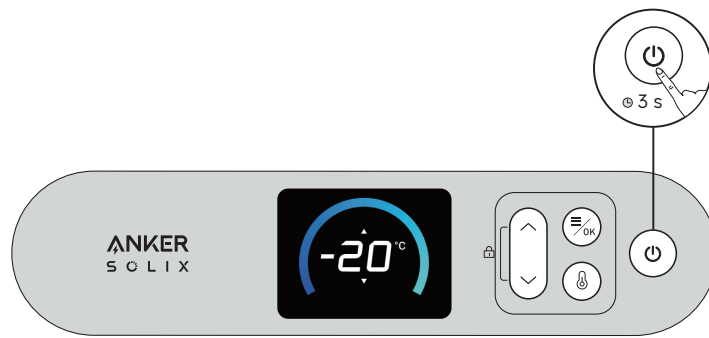

Screen Guide

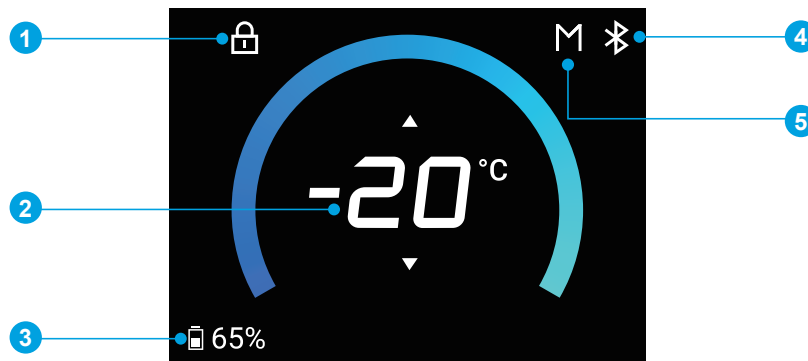

- 1 Child Safety Lock
Press <⏻> once to turn the child safety lock on / off.
- 2 Temperature
- 3 Battery Level
- 4 Wi-Fi / Bluetooth
- 5 Protective Voltage (L / M / H)

Connecting Your Cooler

Bluetooth

The cooler will automatically connect to your phone's Bluetooth, and the icon will turn steady white. If Bluetooth is not connected, press <⏻> for 2 seconds to turn on Bluetooth. The Bluetooth icon on the screen will flash. The Bluetooth function will be turned off after 12 hours without any connection.

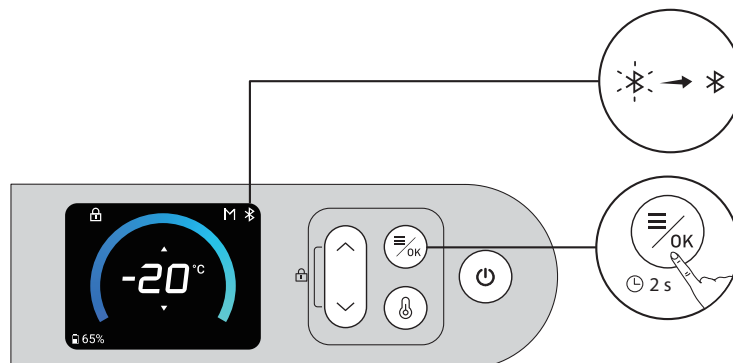

Using the App

1. Connect with Wi-Fi and download the app to remotely control your cooler.

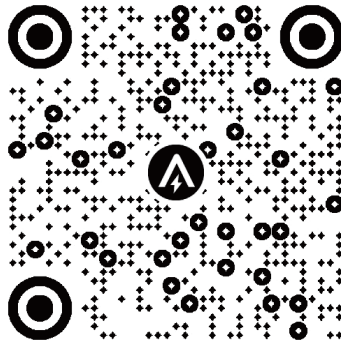

2. Add your cooler.

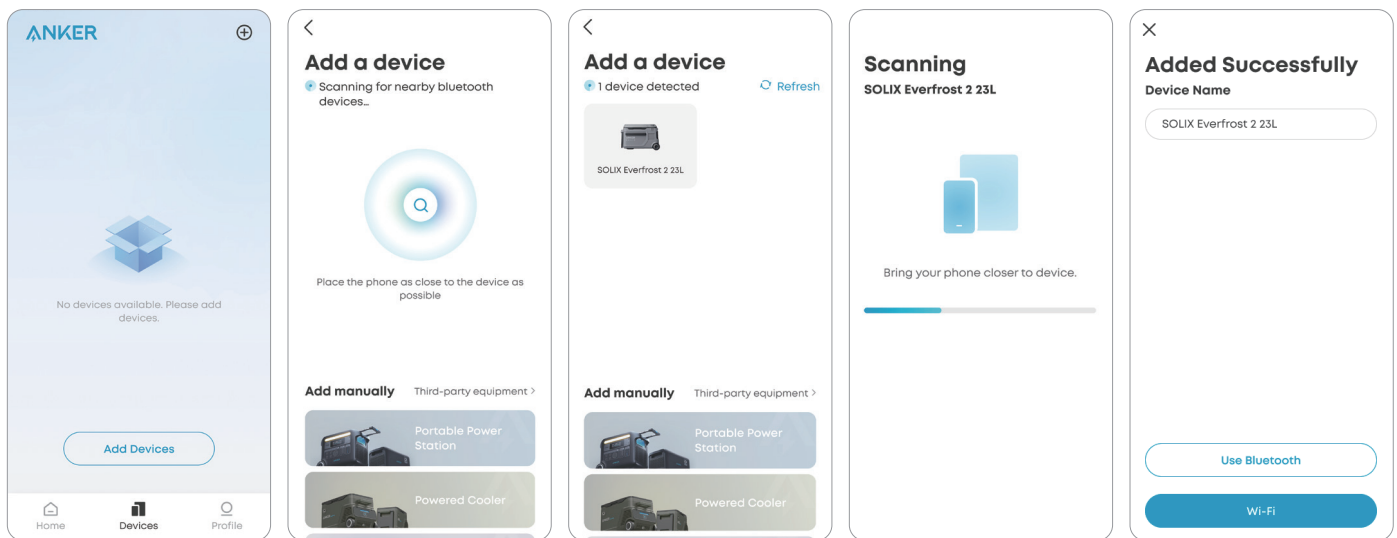

Installing Firmware Updates

You will receive a notification before updates are installed. Your cooler must be charging and connected to Wi-Fi or Bluetooth to complete the update. If there is a battery in the cooler, the battery level needs to be above 1%.

Setting the Temperature

*You can set the temperature in the app or as follows.

Press <ⓘ> once to enter the temperature settings. Then use <⬆> to adjust the temperature. Confirm the temperature and return to the homepage by pressing <⏹>.

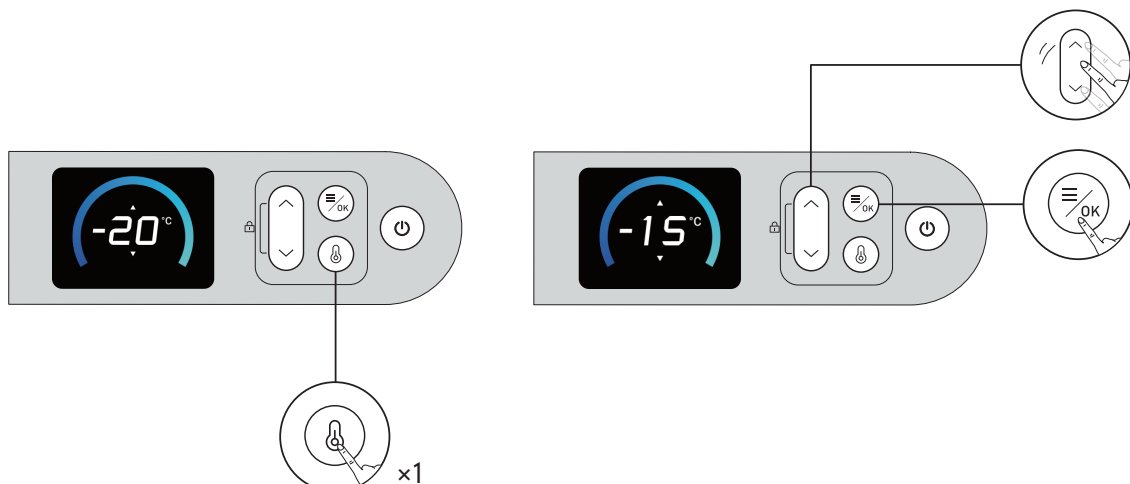

Powering Your Cooler

We do not recommend using multiple charging methods at the same time.

AC Powering

Power the cooler by connecting to a wall outlet with the AC charging cable.

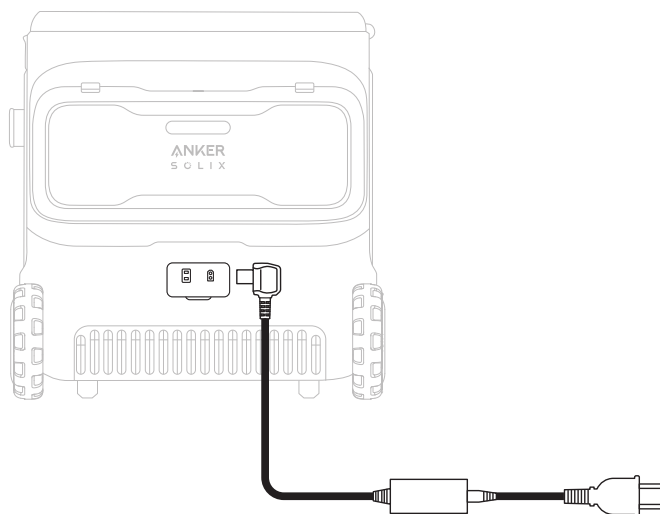



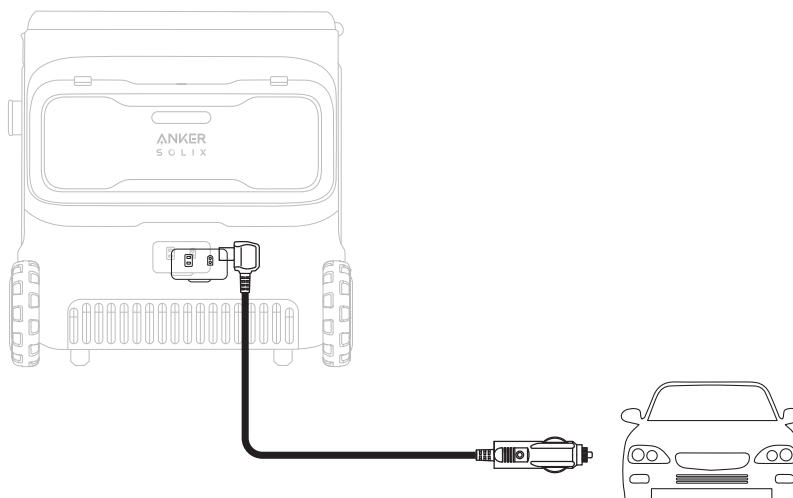

Car Powering

Connect the cooler to a car's output port with the car charging cable.



*Car Battery Protection Grades

The cooler supports three levels of battery protection. To modify the level of battery protection, press <  > first, and then press <  > to choose Protective Voltage, and confirm it by pressing <  >. Continue pressing <  > to choose between "L / M / H", and confirm the level with <  >. When the cooler is connected to a car battery (lead-acid battery), the cooler's battery protection prevents the car battery from over-discharging.

If your cooler does not have a battery and the car's battery voltage is lower than your cooler's set value in that scenario, your cooler will stop working.

If the car's battery voltage reaches the recovery value needed for battery protection, the cooler will return to the power-on/off state it was in before the protection was activated.

If the cooler has a battery and the car battery's voltage is lower than the set value for that scenario, the cooler switches to its own battery power and does not shut down automatically.

Note: When powering the cooler via the car socket of the power station, please set the battery protection grade to "Low" to avoid the battery protection function from being triggered by mistake.

Low

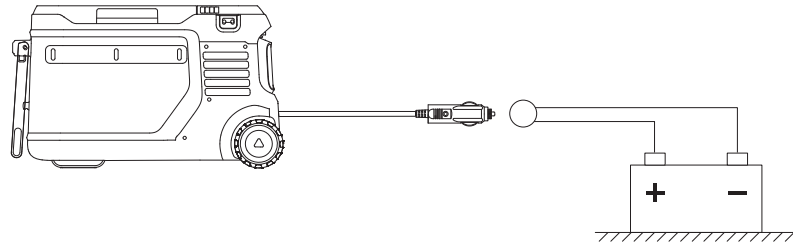

Medium/High

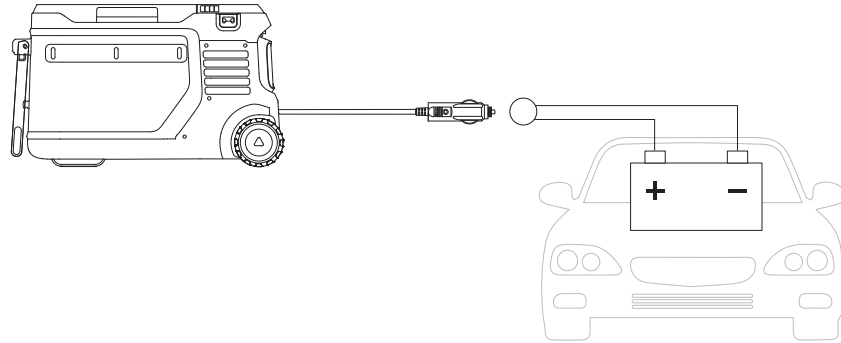

USB-C Powering

Note: The USB-C cable and charger are not included in the package.

Power the cooler by connecting the battery to a wall outlet with the USB-C cable.

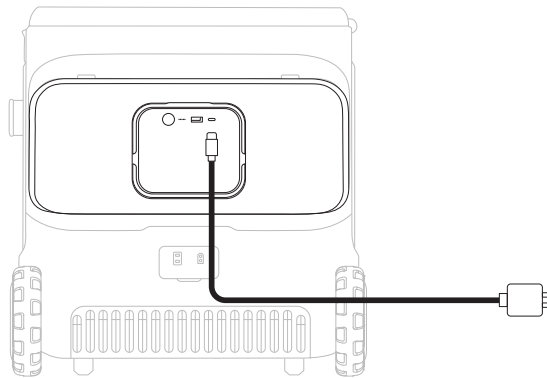

Solar Powering (100 W Max, 12 V-30 V)



- This method of powering can only be used when the battery is in the cooler.
- To protect the compressor's lifespan, the cooler will only be powered when the battery level is at least 5% during solar charging input.

Power the cooler by connecting the battery to a solar panel with an XT60 cable.

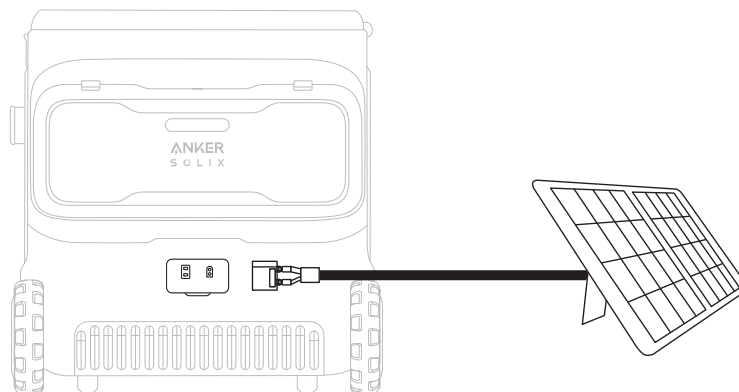

Maintenance Best Practices

- Turn off all power before cleaning to ensure safety.
- Clean after disassembly and then install in reverse order. Do not use excessive force during disassembly to avoid damaging the components.
- Use a soft cloth with a neutral detergent for wiping. Do not use scouring powder, benzene, hydrochloric acid, hot water, coarse brushes, abrasives, or hard objects to clean the cooler, as they may damage or corrode it.
- Regularly clean the interior and exterior of the cooler with a damp cloth.
- Never use running water to wash the interior and exterior of the cooler or immerse it in water.
- To ensure that the cooler is able to ventilate and dissipate heat, the air inlet and outlet must be free of dust and dirt.
- After cleaning the cooler, check the power cord for any damage or moisture, and ensure that the plug is not overheated. Make sure everything is in order before connecting the power supply.
- Before connecting the power, dry the cleaned cooler with a soft dry cloth or sponge. This will prevent water or other liquids from remaining in the electrical components, which may cause electric shock or short circuit hazards.
- We recommend placing the cooler on a level surface for use. When the tilt angle exceeds 30°, it will affect the normal operation of the compressor.

FAQ

1. What type of battery does the cooler use?

LFP (Lithium Iron Phosphate) battery.

2. Can the cooler be connected to the solar panel without the battery?

No. The cooler must have a battery inside when a solar panel is connected. Otherwise, the cooler will not work.

3. Is there anything to be aware of when using the cooler for the first time?

We recommend laying the cooler flat for three hours before turning it on for the first time.

4. When there is a battery in the cooler, does the external power supply give priority to charging the battery or supplying power to the cooler?

The external power supply will prioritize charging the cooler.

5. Can the cooler be transported for long periods?

Yes. Make sure to lay the cooler flat for three hours before turning it on after a long transportation.

6. What's the maximum load capacity of the bar?

It's 30 kg / 66.1 lb.

7. Is it normal to have a smell when I first use the cooler?

Yes. During production, foaming agents are used for better thermal insulation. These agents leave a slight residual smell, but it's harmless. Before using it for the first time, place the cooler in a well-ventilated area with the cover open.

Specifications

Cell Capacity	288 Wh
Capacity	23 L / 24.3 qt
Size	668 × 400 × 385 mm / 26.3 × 15.7 × 15.2"
Battery Compartment	1
Temperature Range	-20°C to 20°C / -4°F to 68°F
AC Input Power (Charging)	95 W Max
Solar Panel Input	12-30 V = 8.2 A (100 W Max)
USB-C1 Input	5 V = 3 A / 9 V = 3 A / 15 V = 3 A / 20 V = 3 A (60 W Max)
USB-A Output	5 V = 2.4 A (12 W)
USB-C1 Output	5 V = 3 A / 9 V = 3 A / 15 V = 3 A / 20 V = 3 A (60 W Max)
Discharging Temperature	-20°C to 40°C / -4°F to 104°F
Charging Temperature	0°C to 40°C / 32°F to 104°F
Waterproof	IPX3
Net Weight	16.8 kg / 37 lb